

# EICG-1-HSN-H

The EICG-1-HSN utilizes hinges in the arms for various insulator heights. The conductor, when top tied, varies in height on different insulators. A pin type ANSI class 55-5 is lower than an ANSI class 57-3 therefore the conductor height relative to the cover varies. The hinges allow the arms to drop onto the conductor and actually float. The hinges also allow for downstrains for each side of the insulator. The cover is installed in 3 pieces. The insulator cover with short adapter arms is installed first. Then the arms are added and pinned. The installation is designed to be dropped on the insulator and conductor. There is no forcing or pulling to install the cover. Simply drop it on the insulator. The EICG-1-HSN utilizes narrow profile arms. For wider arms see EICG-1-HSW. Designed for ANSI 55-4, 55-5, 57-1, 57-2, 57-3 porcelain and polymer insulators F neck. Available in FR, UL 94 5VA rated.

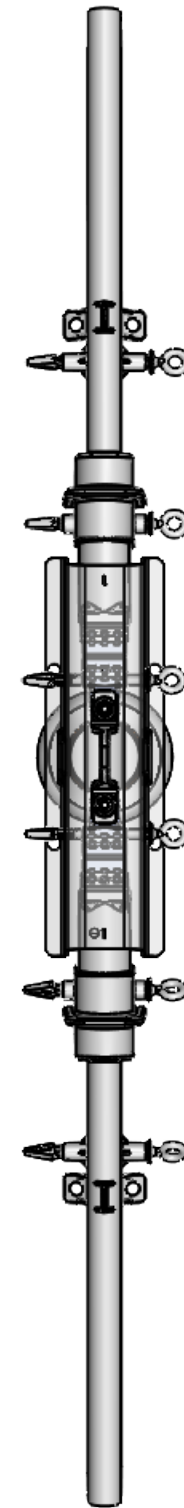
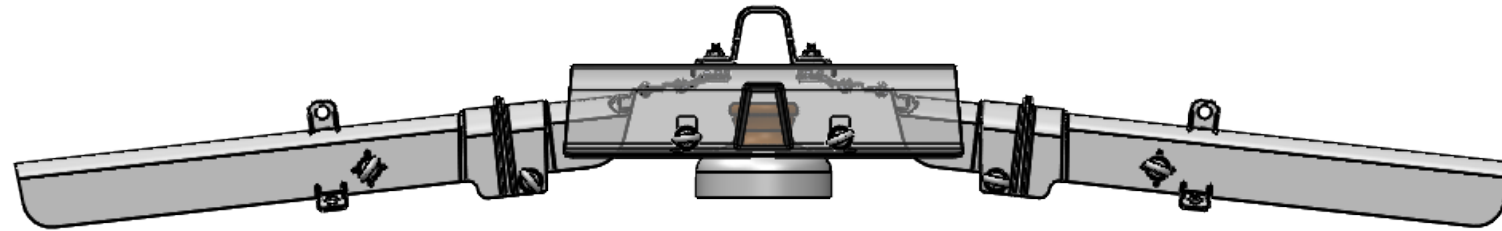

**Warning!** 

1. High Voltage can cause death or serious injury.
2. This product is NOT PPE (Personal Protective Equipment). It is not designed to protect humans from electrical hazards, electrical arcs, or flashover.
3. Always follow safe working procedures, safety standards, and guidelines. Always use approved live line tools and PPE, rubber gloves, and sleeves if required, during installation, removal, and maintenance.

**PROPRIETARY AND CONFIDENTIAL**  
 THE INFORMATION CONTAINED IN THIS DRAWING IS THE SOLE PROPERTY OF ECO ELECTRICAL SYSTEMS. ANY REPRODUCTION IN PART OR AS A WHOLE WITHOUT THE WRITTEN PERMISSION OF ECO ELECTRICAL SYSTEMS IS PROHIBITED.

		UNLESS OTHERWISE SPECIFIED:		NAME	DATE
		DIMENSIONS ARE IN INCHES TOLERANCES: FRACTIONAL ANGULAR: MACH BEND TWO PLACE DECIMAL THREE PLACE DECIMAL		DRAWN	ML 6/4/20
		INTERPRET GEOMETRIC TOLERANCING PER:		CHECKED	
		MATERIAL		ENG APPR.	
		HDPE		MFG APPR.	
NEXT ASSY		USED ON		Q.A.	
		FINISH		COMMENTS:	
		SMOOTH			
APPLICATION		DO NOT SCALE DRAWING		TITLE:  EICG-1-HSN-H	
				SIZE	DWG. NO.
				<b>B</b>	
				REV <b>1</b>	
				WEIGHT:	
				SHEET 1 OF 1	